



**503 WILTSHIRE Lane DELACOMBE VIC**

5 🛏 3 🚿 4 🚗

Perfect Delacombe location amidst quality homes and larger land parcels. This modern home (44.91sq total) offers many accommodation options including a fully established wheelchair-friendly dependent persons 1 bedroom flat complete with spa, and spacious living areas. — ideally suited to the elderly, teenagers, or simply extra income. The home itself comprises 4 generous bedrooms and study, 2 separate living areas, full ensuite, corner spa and large vanity to main bathroom, quality timber joinery, 2.7m ceilings, security and intercom systems, central vacuum, ducted heating, double garage with remote, extra garaging, water tank, orchard, hothouse, paved pergola and private courtyard space. Truly a magnificent home with low maintenance features yet much potential for tradesmen, hobbyists and those with carers requirements. 1697m2 block.

**Building Size** : 45 sqm  
**Land Size** : 1697 sqm  
**View** : <https://www.doepels.com.au/sale/vic/ballarat-western-district/delacombe/residential/house/6187237>



**John Morris**  
03 5331 2000

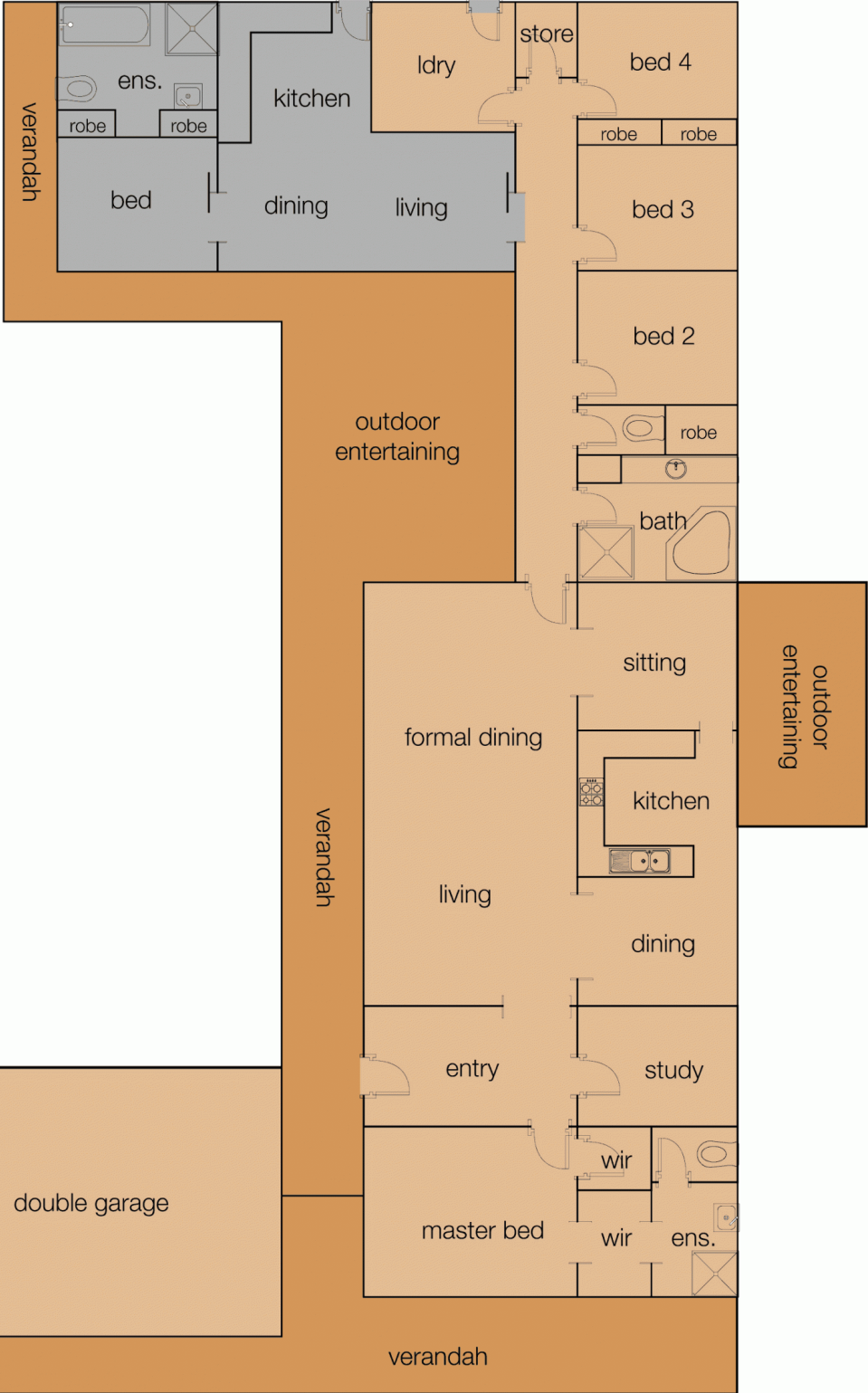
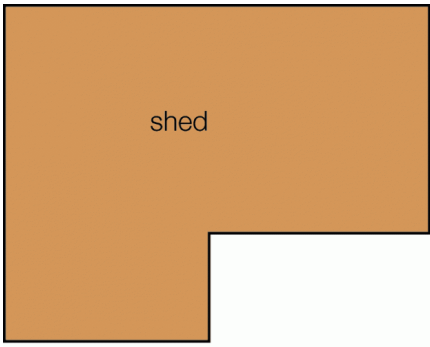



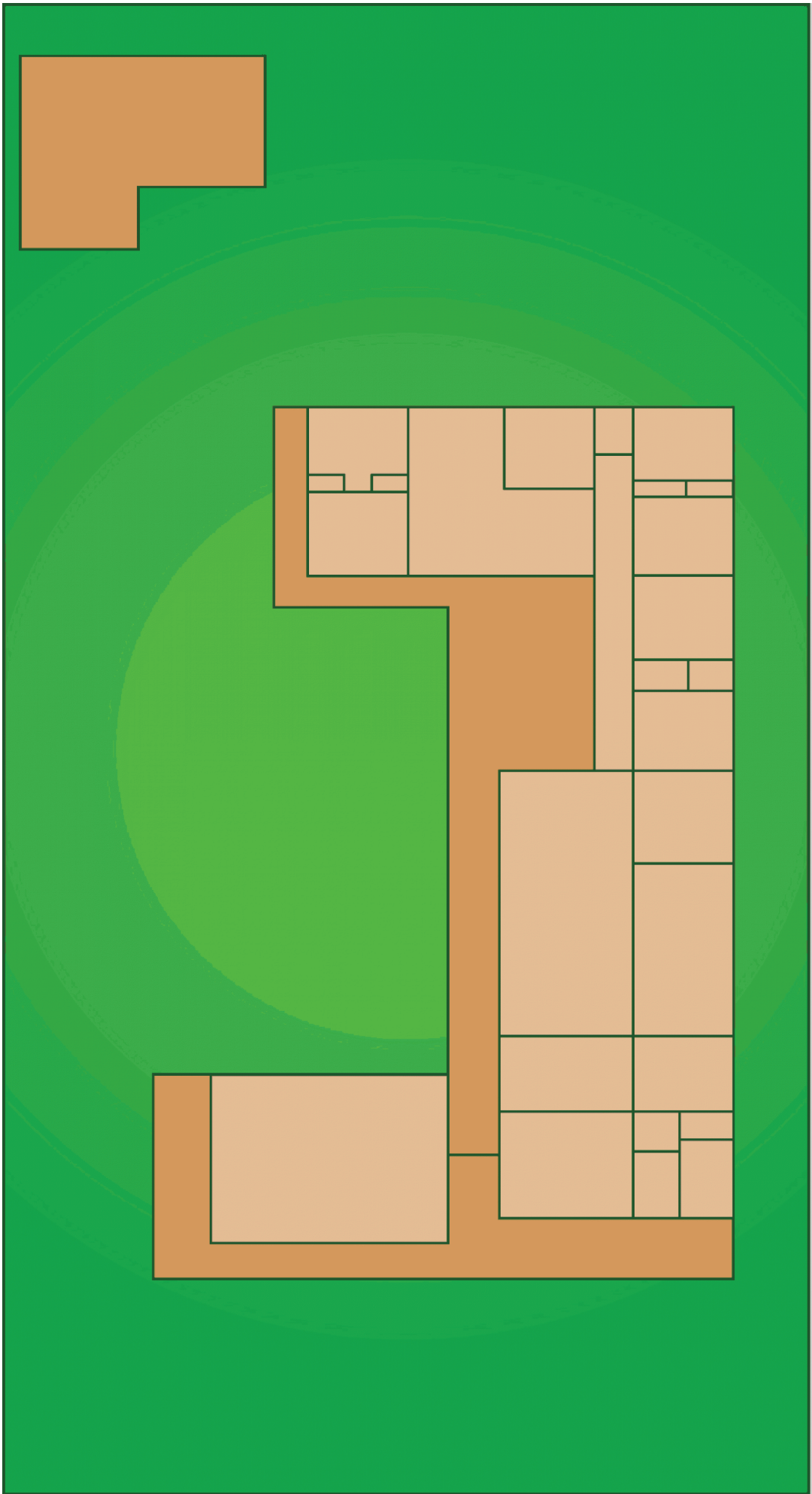

site plan