



4 Lake Street Lake Wendouree VIC

5 🏠 3 🚗 3 🚗

BUILT circa 1900, this classic Victorian solid brick period home known as "Rosedale" will draw incredible interest due to its historic build, location and restored period elements with an addition of a modern architectural extension and luxury inclusions. This property with high 12" ceilings and grand proportions combined with modern design is still laced with period details like ceiling roses, ornate cornice and timber floors that will please even the most fastidious of buyers and is located only metres to Lake Wendouree.

This truly inspired home is superbly zoned for easy family living/entertaining, oriented for maximum natural light, passive solar energy and is located close to the Lake, Hospitals and city centre on an allotment of app 763sqm. Featuring 4 spacious bedrooms, all with built in robes. Master bedroom with superb large ensuite and walk in robe. The 3rd bedroom has direct access to a bathroom

Land Size : 763 sqm

View : <https://www.doepels.com.au/sale/vic/ballarat-western-district/lake-wendouree/residential/house/6187682>



Robert Cunningham
5337 0040



Tony Lockyer
03 5331 2000

TOTAL LIVING AREA: APPROX. 33 SQ

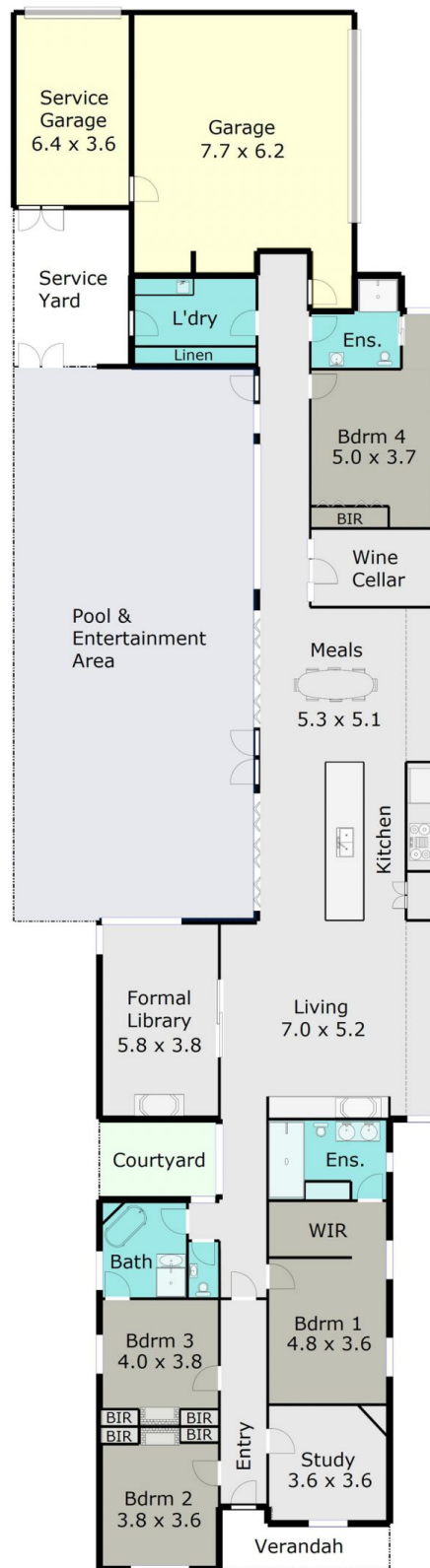

DISCLAIMER:

ALL DIMENSIONS ARE APPROXIMATE & NOT 100% TO SCALE.
FOR FURTHER INFORMATION, PLEASE CONTACT YOUR AGENT DIRECTLY.

