



208 Doveton Street South Ballarat Central VIC

4 🛏 1 🚿 1 🚗

Positioned just two blocks from Sturt St, in an enviable central location is this grand period home, sure to be popular with buyers especially owner occupiers wanting an imposing central property. Those looking to inhabit are bound to be impressed by the sheer size, great structure and character the home presents. With plenty of room to extend and the scope for reward on the existing home being large this is sure to please all, especially those looking to break into the tightly held central market. Previously an Osteopathic Clinic, with an abundance of rear parking and 5 consulting rooms this is an attractive option to continue STCA. Just over 500m to Sturt St, being able to walk to explore everything that Ballarat has to offer has never been easier. Inspections are a must.

Land Size : 640 sqm
View : <https://www.doepels.com.au/sale/vic/ballarat-western-district/ballarat-central/residential/house/6187737>



Robert Cunningham
5337 0040



Tony Lockyer
03 5331 2000

TOTAL LIVING AREA: APPROX. 14.8 SQ

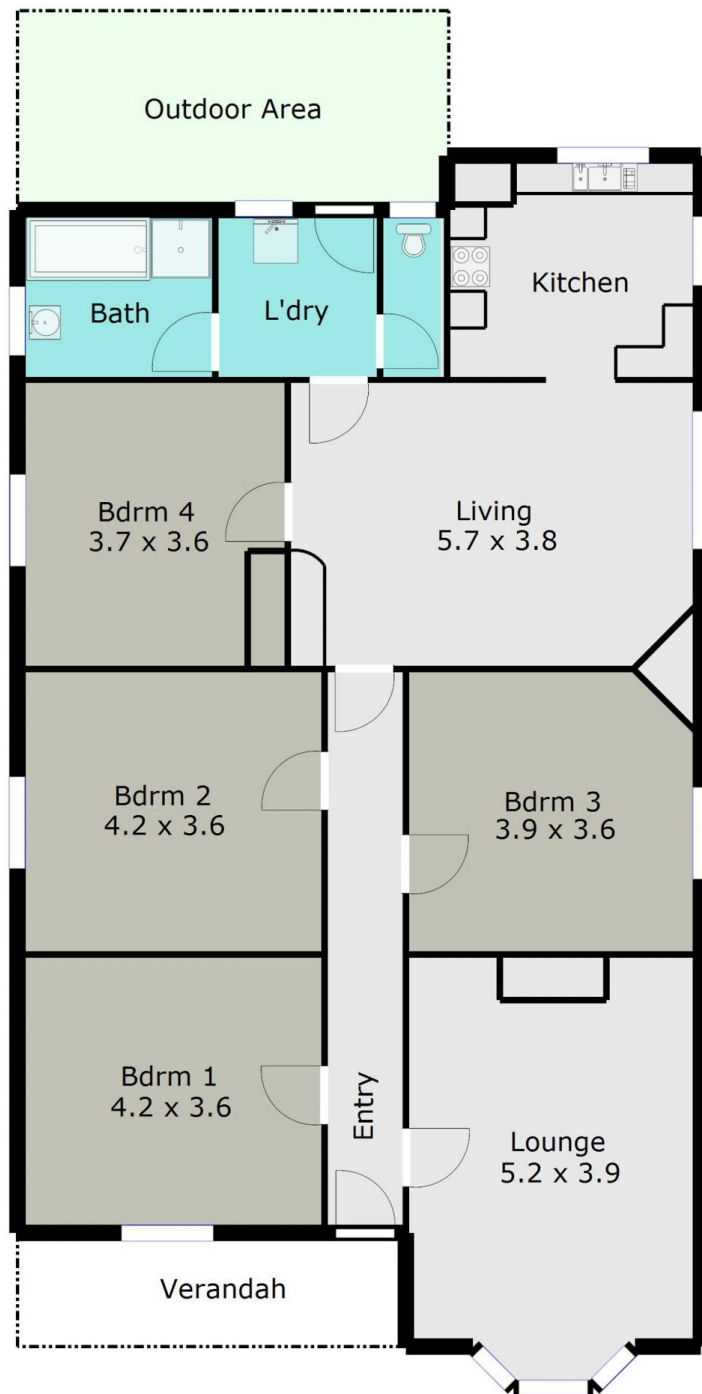

DISCLAIMER:

ALL DIMENSIONS ARE APPROXIMATE & NOT 100% TO SCALE.
FOR FURTHER INFORMATION, PLEASE CONTACT YOUR AGENT DIRECTLY.

