



7 Annmaree Drive Winter Valley VIC

4 2 2

A fantastic large family home that ticks all the boxes for comfort, convenience and style to suit growing families, or a great opportunity to grow the astute investor's portfolio! Being nestled opposite to the Kensington Creek parkland reserve only enhances the picturesque street appeal, enjoy having local walking tracks right on your doorstep and Yorkdale Estate playground.

An impressive and well-presented four-bedroom home with two bathrooms and two living zones that sits on a prime 600m² allotment just minutes to the Delacombe Town Centre, also within easy access to Lucas Coltman Plaza, both offering a variety of close and handy daily amenities including medical, shops, childcare, schools, playgrounds, recreational and entertainment and only a short drive to the Ballarat CBD.

Price : \$535,000-\$550,000
Land Size : 600 sqm
View : <https://www.doepels.com.au/sale/vic/ballarat-western-district/winter-valley/residential/home/8110779>



Matthew Tunbridge
03 5331 2000

Internal 164m² External 436m² Total 600m²

7 Anmaree Drive, **Winter Valley**



4 x 2 x 2 x

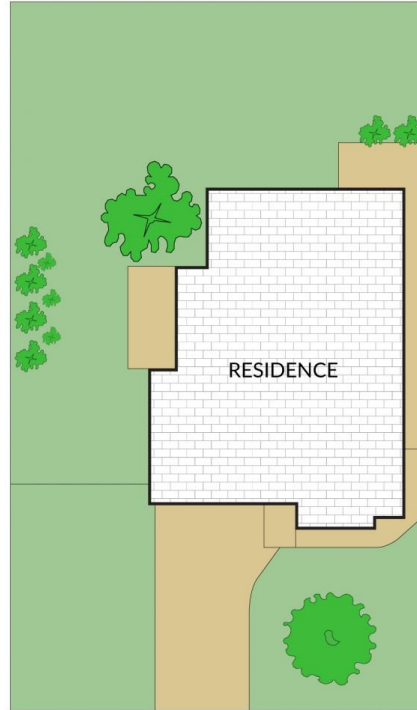
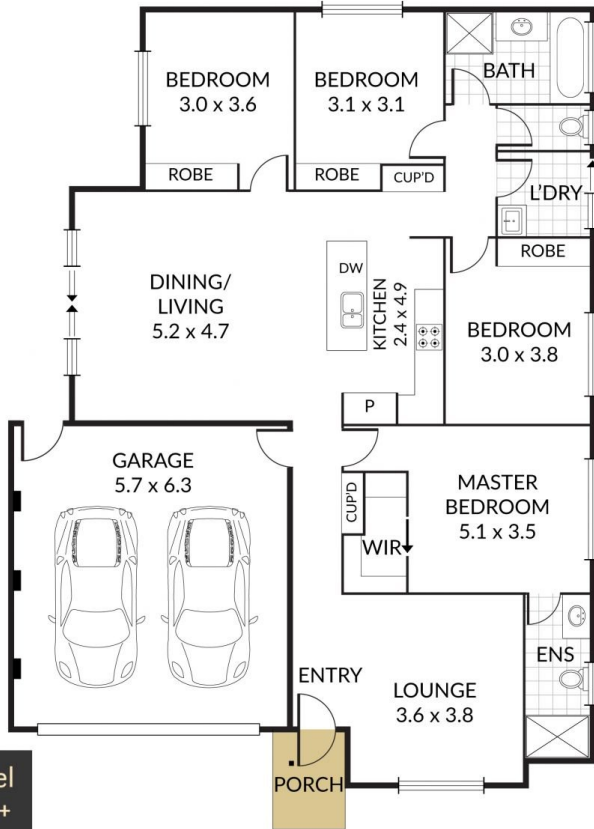

**Doepel
Lilley +
Taylor**
Real Estate. Est 1888

NOTE: Every precaution has been taken to verify the accuracy of the above details. However, prospective purchasers are advised to make their own enquiries.